

PANEL MOUNTING HOLE

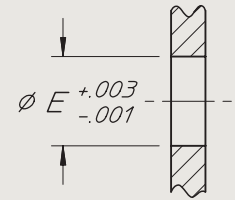

©2002 DUPREE, INC.

PART NO. EXAMPLE: **SF 6G 6C BA5 D**

HEAD TYPE	B THICKNESS								T THREAD		C APPENDAGE TYPE & LENGTH				A	D	E	MATERIAL	
	.04	.05	.06	.08	.09	.10	.12	.15	.18	CODE	SIZE	$\frac{3}{32}$	$\frac{1}{8}$	$\frac{5}{32}$	$\frac{3}{16}$	MAJ. DIA.	APP. DIA.		MTG. HOLE DIA.
SF	4E	5E	6E							2C	.086-56 UNC-3B	BA3				.219	.110	.156	D HIGH CARBON STEEL (SEE NOTE 1)
	4F	5F	6F	8F	9F	10F	12F			4C	.112-40 UNC-3B		BA4			.250	.139	.188	
	4G	5G	6G	8G	9G	10G	12G			6C	.138-32 UNC-3B			BA5		.281	.165	.219	
			6H	8H	9H	10H	12H	15H		8C	.164-32 UNC-3B			BA5		.312	.204	.250	
			6J	8J	9J	10J	12J	15J	18J	10F	.190-32 UNF-3B				BA6	.375	.229	.312	
				8L	9L	10L	12L	15L	18L	14F	.250-28 UNF-3B				BA6	.438	.300	.375	

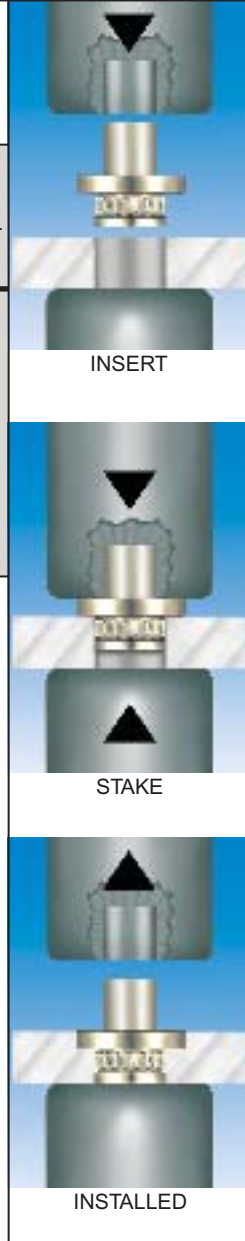

FEATURES:

1. The pressure displacement principle provides a fastener made of a relatively strong material installed into a relatively soft mounting material.
2. The BA fastener provides a steel threaded hole in a relatively soft material, flush with both surfaces of the mounting sheet, except for the protruding self-locking appendage.

NOTES:

1. High carbon steel (Material Code **D**) parts are stock items. Parts made of type 303 corrosion resistant steel (MIL-S-7720) are available, on order, by using Material Code **C**.
2. Parts are installed by pressure displacement principle as illustrated by figures. Pressure is applied between a punch and an anvil which may be installed in any suitable equipment, such as hydraulic or impact punch presses. A clearance hole is shown in the punch to accommodate the self-locking appendage.

Pressure to be applied will vary with fastener size, sheet thickness and type of material used.

3. Sheet material must be ductile and capable of forming into knurled recess of fastener without stress cracking.
4. In all cases the fastener should be installed to allow screw threads to enter the side opposite the large flange. When the screw is cinched at installation, the forces are applied against the large flange.

SPECIFICATIONS:

1. Steel fasteners (Material Code **D**) are made of chrome molybdenum alloy per AISI4140 (or equal).
2. Steel fasteners (Material Code **D**) are cadmium plated per QQ-P-416, Type II, Class 2.
3. Corrosion resistant steel fasteners (Material Code **C**) are passivated per QQ-P-35.

STAKE FASTENER CO.

14395 RAMONA AVENUE
CHINO, CALIFORNIA 91710

(909) 597-4889
CAGE 12324

FAX (909) 597-3043
sales@stakefastener.com



FASTENER

TYPE BA
PRESSURE DISPLACEMENT