

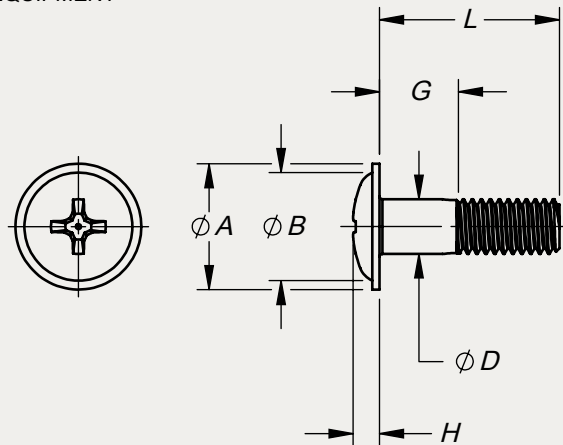

TYPICAL APPLICATION:
SECURING PANELS AND RACK
MOUNTED EQUIPMENT



© 2016 DUPREE, INC.

PART NO. EXAMPLE: **WH 10 R10 D S15BG** = WASHER HEAD SCREW, .190-32 UNF-3A X 5/8" LG, 7/32" GRIP, ALLOY STEEL, CRUCIFORM RECESS, SEMI-GLOSS BEIGE PER FED-STD-595 NO. 27722

HEAD TYPE	THREAD		RECESS / LENGTH CODE	MATERIAL	COLOR CODE	DIM DATA SEE NASM525			
	CODE	SIZE				A	B	D	H
WH	8	.164-36 UNF-3A	DESIGNATES RECESS TYPE & PART LENGTH	D	SEE STOCK COLOR LIST Doc No. SCL870115	.375	.312	.164	.087
	832	.164-32 UNC-3A	"R" DESIGNATES CRUCIFORM RECESSED HEAD SCREWS			.375	.312	.164	.087
	10	.190-32 UNF-3A	SEE TABLE 1 FOR AVAILABLE LENGTHS			.437	.375	.190	.094
	416	.250-28 UNF-3A				.500	.437	.250	.101

TABLE 1: AVAILABLE DIAMETERS & LENGTHS

"L" LENGTH ± 1/32	"G" GRIP	DASH NUMBERS FOR CRUCIFORM RECESSED HEAD SCREWS			
		.164-36UNF-3A (#8-36)	.164-32UNC-3A (#8-32)	.190-32UNF-3A (#10-32)	.250-28UNF-3A (1/4-28)
3/8	1/32	8R6	832R6	10R6	416R6
7/16	1/16	8R7	832R7	10R7	416R7
1/2	1/8	8R8	832R8	10R8	416R8
9/16	5/32	8R9	832R9	10R9	416R9
5/8	7/32	8R10	832R10	10R10	416R10
11/16	9/32	8R11	832R11	10R11	416R11
3/4	11/32	8R12	832R12	10R12	416R12
7/8	15/32	8R14	832R14	10R14	416R14
1	19/32	8R16	832R16	10R16	416R16
1-1/8	23/32	8R18	832R18	10R18	416R18
1-1/4	27/32	8R20	832R20	10R20	416R20
1-3/8	31/32	8R22	832R22	10R22	416R22
1-1/2	1-3/32	8R24	832R24	10R24	416R24
1-5/8	1-7/32	8R26	832R26	10R26	416R26
1-3/4	1-11/32	8528	832R28	10R28	416R28
1-7/8	1-15/32	8R20	832R30	10R30	416R30
2	1-19/32	8R32	832R32	10R32	416R32

STAKE FASTENER CO.

14395 RAMONA AVENUE
CHINO, CALIFORNIA 91710
(909) 597-4889 FAX (909) 597-3043
CAGE 12324 sales@stakefastener.com



COLORED SCREW

WASHER HEAD, MACHINE THREAD,
ALLOY STEEL, PLATED
(SHEET 1 OF 2)

FEATURES:

1. Screws are furnished with pre-colored heads to match panels and equipment. The coating material used in combination with the relatively hard screw heads is resistant to abrasion and screwdriver damage. This feature virtually eliminates the need for touch-up painting after assembly.
2. Screw heads are formed by cold forging, followed by a heat treating process which increases the basic tensile strength of the material. The resultant high tensile strength thus eliminates burring and yield of the substrate under the coating material.
3. Screw heads are cleaned and prepared for maximum adhesion of the coating material. The thermosetting coating material is both abrasion and solvent resistant.

NOTES:

1. The screws listed in this series reflect high quality with emphasis on the forming of the cruciform recess to meet design specification.
2. Care should be exercised to assure that the screwdriver tools meet the same quality and design specification in order to eliminate mismatching and subsequent damage to the drive recess and coating material.
3. The thread diameters and lengths listed in the table are NASM525 standard sizes. Inventory levels of these sizes may vary at any one time due to customer demands and lead time necessary for production.

SPECIFICATIONS:

1. Screws meet all requirements of NASM525.
2. Screw material is alloy steel per NASM525.
3. Screws are cadmium plated per AMS-QQ-P-416, Type II, Class 3 or zinc plated per ASTM B633, Fe/Zn 13, Type II, as per NASM525.
4. Threads are in conformance with FED-STD-H28/2, Federal Handbook for threads.
5. Thermosetting coating material is applied to screw head only. Threads are free of coating.
6. Screw head coating colors are matched to customer requirements. We recommend selection from FED-STD-595 whenever possible but we are also prepared to match customer-furnished color chips or samples.
7. Previous to NASM525, Revision 2 (released 30-JUN-2010), the nominal length ("L" dimension) did not include the end chamfer. Part inventory manufactured to previous revisions may be procured and used until stock is depleted. For further details, refer to Stake Fastener Co. dwg no. 9-83-0401-105.

STAKE FASTENER CO.

14395 RAMONA AVENUE
CHINO, CALIFORNIA 91710
(909) 597-4889 FAX (909) 597-3043
CAGE 12324 sales@stakefastener.com



COLORED SCREW
WASHER HEAD, MACHINE THREAD,
ALLOY STEEL, PLATED
(SHEET 2 OF 2)